

A66 Northern Trans-Pennine Project

Scheme 0102: M6 Junction 40 to Kemplay Bank

TR010062

5.13 Land Plans

(Rev 3)

APFP Regulations 5(2)(i)

Planning Act 2008

Infrastructure Planning (Applications: Prescribed Forms and
Procedure) Regulations 2009

Deadline 7 - May 2023

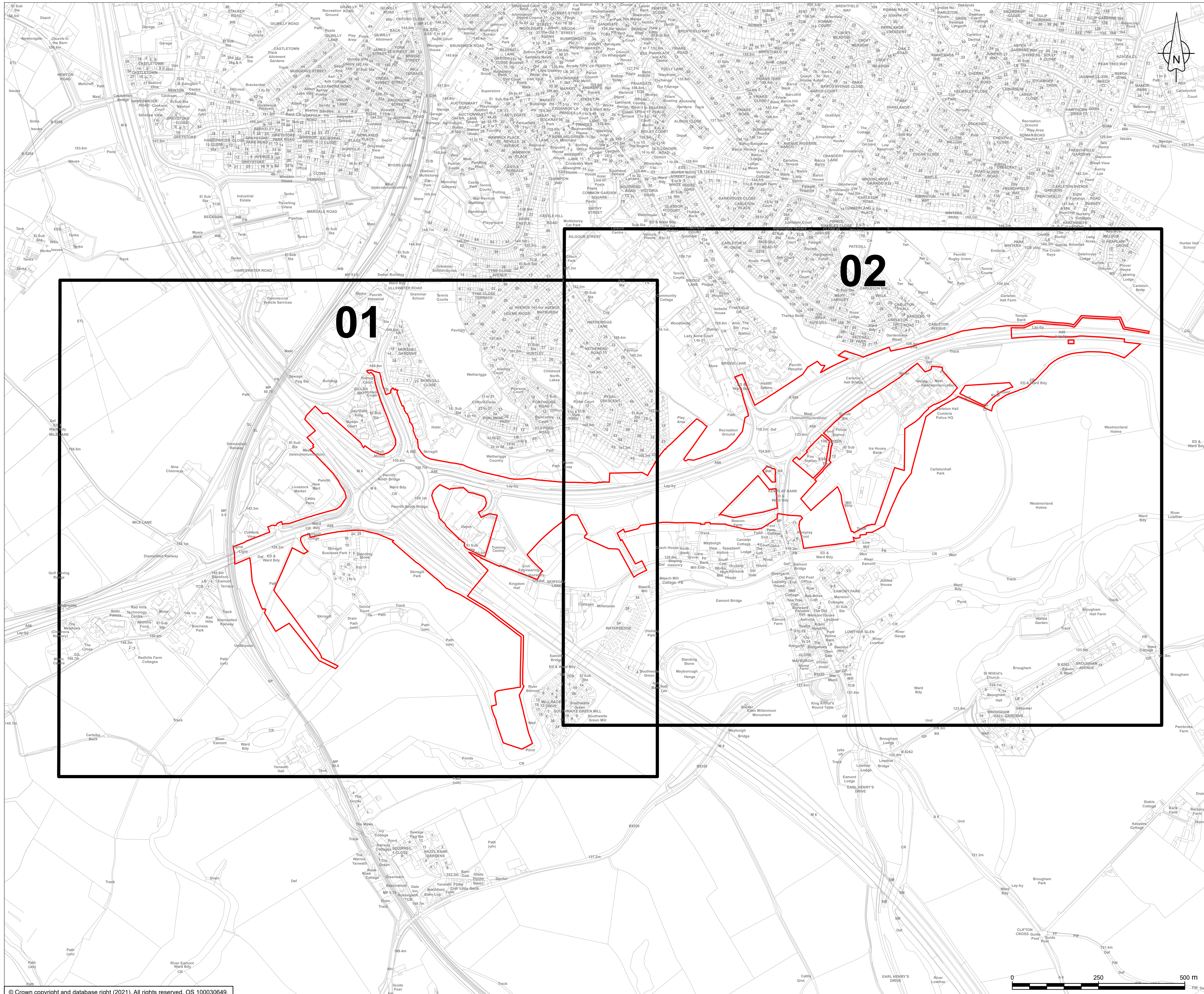

NOTES

1. ALL DIMENSIONS ARE IN METRES UNLESS STATED OTHERWISE.
2. THESE LAND PLANS SHOULD BE READ IN CONJUNCTION WITH OTHER PLANS AND DOCUMENTS IN THE DEVELOPMENT CONSENT ORDER APPLICATION IN PARTICULAR THE BOOK OF REFERENCE.
3. ALL EASEMENTS, SERVITUDES AND PRIVATE RIGHTS IN LAND ARE PROPOSED TO BE EXTINGUISHED ON LAND SHOWN COLOURED PINK ON THESE LAND PLANS. ALL EASEMENTS, SERVITUDES AND PRIVATE RIGHTS IN LAND ARE PROPOSED TO BE EXTINGUISHED, SO FAR AS THEIR CONTINUED EXERCISE WOULD BE INCONSISTENT WITH THE EXERCISE OF THE RIGHTS OR RESTRICTIONS PROPOSED TO BE ACQUIRED BY THE UNDERTAKER ON LAND SHOWN COLOURED BLUE ON THESE LAND PLANS. ALL EASEMENTS, SERVITUDES AND PRIVATE RIGHTS ARE PROPOSED TO BE SUSPENDED WHILE THE UNDERTAKER IS IN TEMPORARY POSSESSION OF THE LAND SHOWN COLOURED GREEN ON THESE LAND PLANS.
4. THE NUMBER LABELS RELATE TO PLOT NUMBERS. PLEASE REFER TO THE BOOK OF REFERENCE FOR MORE INFORMATION ABOUT THESE PLOTS, INCLUDING THE APPROXIMATE AREA OF EACH PLOT (IN SQUARE METRES). PLOT NUMBERS INCLUDE A REFERENCE TO THE RELEVANT SHEET OF THE LAND PLANS. IN THIS NUMBERING CONVENTION, A PLOT NUMBER COMPRISES THE SCHEME NUMBER, FOLLOWED BY THE SHEET NUMBER (OF THE SET OF LAND PLANS RELATING TO THAT NUMBERED SCHEME), FOLLOWED BY THE ACTUAL PLOT NUMBER ON THAT SHEET. E.G. PLOT 03-01-24 WHERE 03 IS THE SCHEME NUMBER (SCHEME 03), 01 IS THE SHEET NUMBER (SHEET 01 OF THE LAND PLANS FOR SCHEME 03) AND 24 IS THE PLOT NUMBER (PLOT 24 ON SHEET 01).

KEY

- ORDER LIMITS
- SHEET USED AS PART OF THE DRAWING SERIES

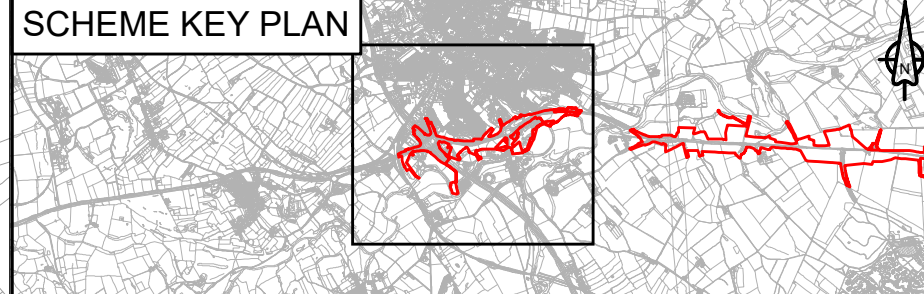
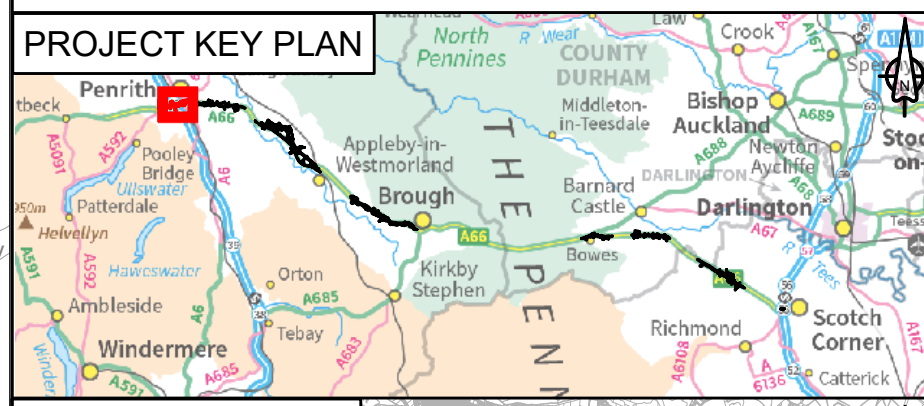

C01	JHILL	JHILL	NWHIT	GEAC	PCAR
	06/06/22	06/06/22	07/06/22	07/06/22	08/06/22
Revision	Revision details				
	JHILL	JHILL	NWHIT	GEAC	PCAR
	20/04/2023	20/04/2023	20/04/2023	20/04/2023	20/04/2023

Purpose
DCO APPLICATION

PINS Reference Number
TR010062/APP/5.13

Client
3 Piccadilly Place
Manchester
M1 3BN

Project Name / Scheme Name
A66 Northern Trans-Pennine Project
Scheme 0102
M6 Junction 40 to Kemplay Bank

Drawing Title
Land Plans
Regulation 5(2)(i)
Key Plan

Project Ref. No.	Stage	Scale : 1:5,000 @ A1
---	PCF3	Dimension : M

Drawing Number	Project	Originator	Volume
HE565627	- AMY	- HAC	-
S0102	- DR	- CH	- 000001
Location	Type	Role	Number

Suitability	Suitability Description	Revision
S0	Initial non-contractual code	C02



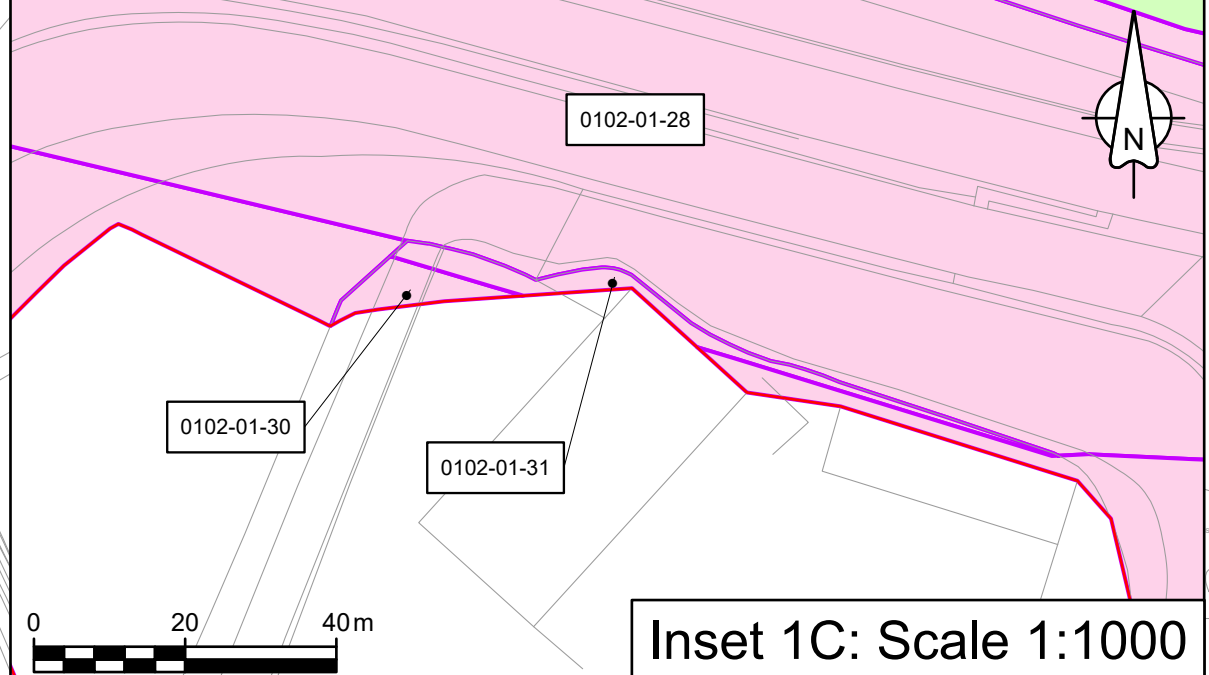
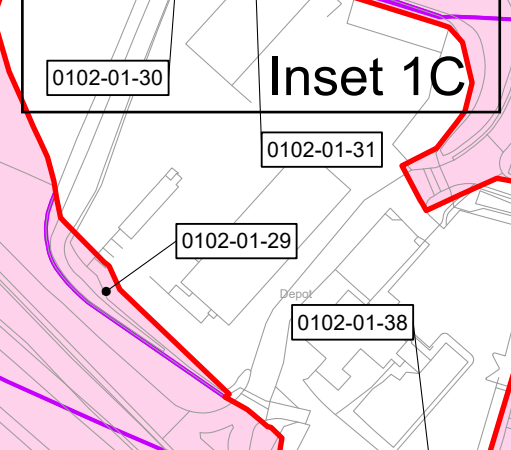
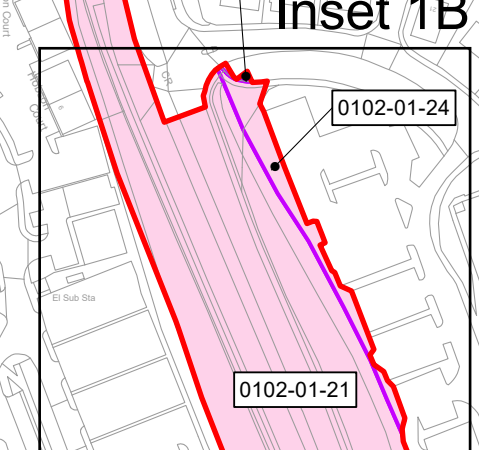
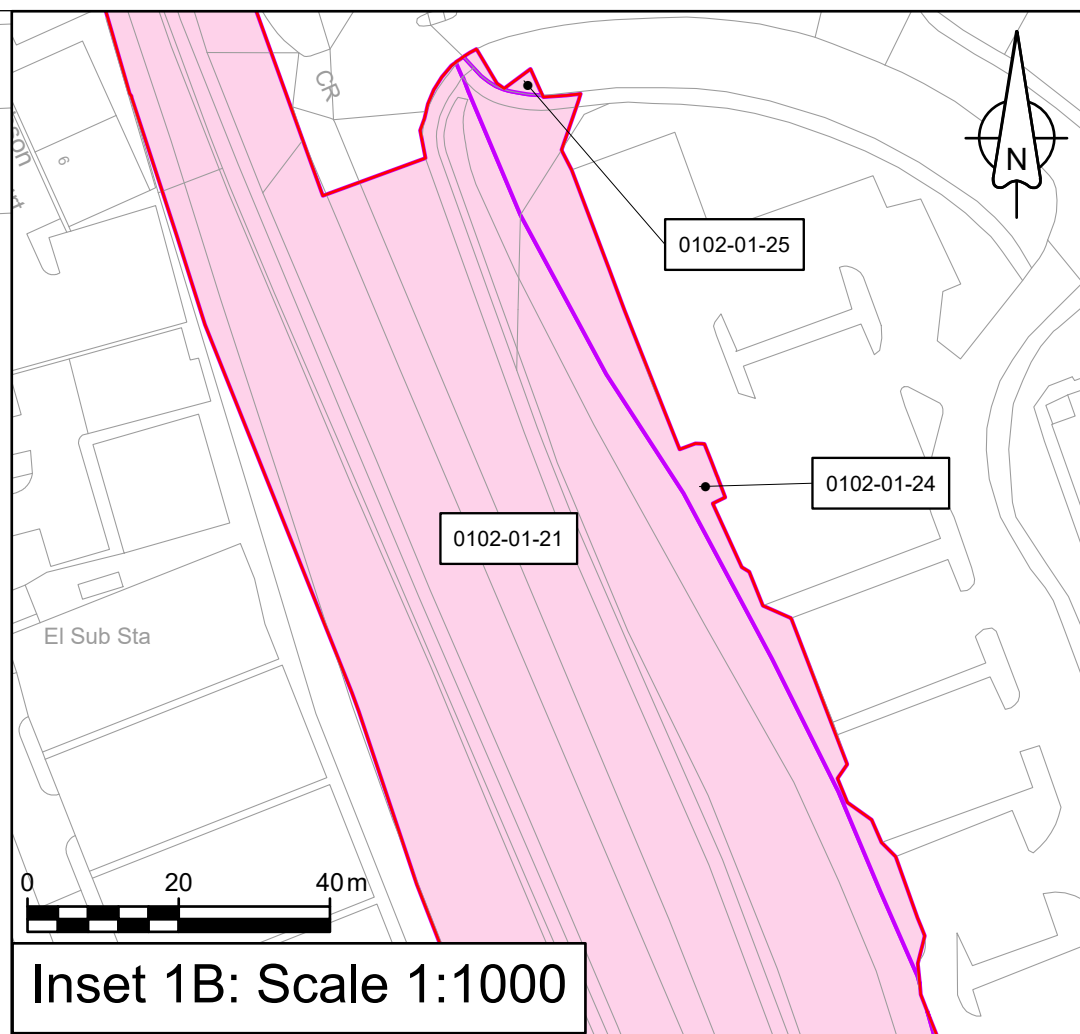
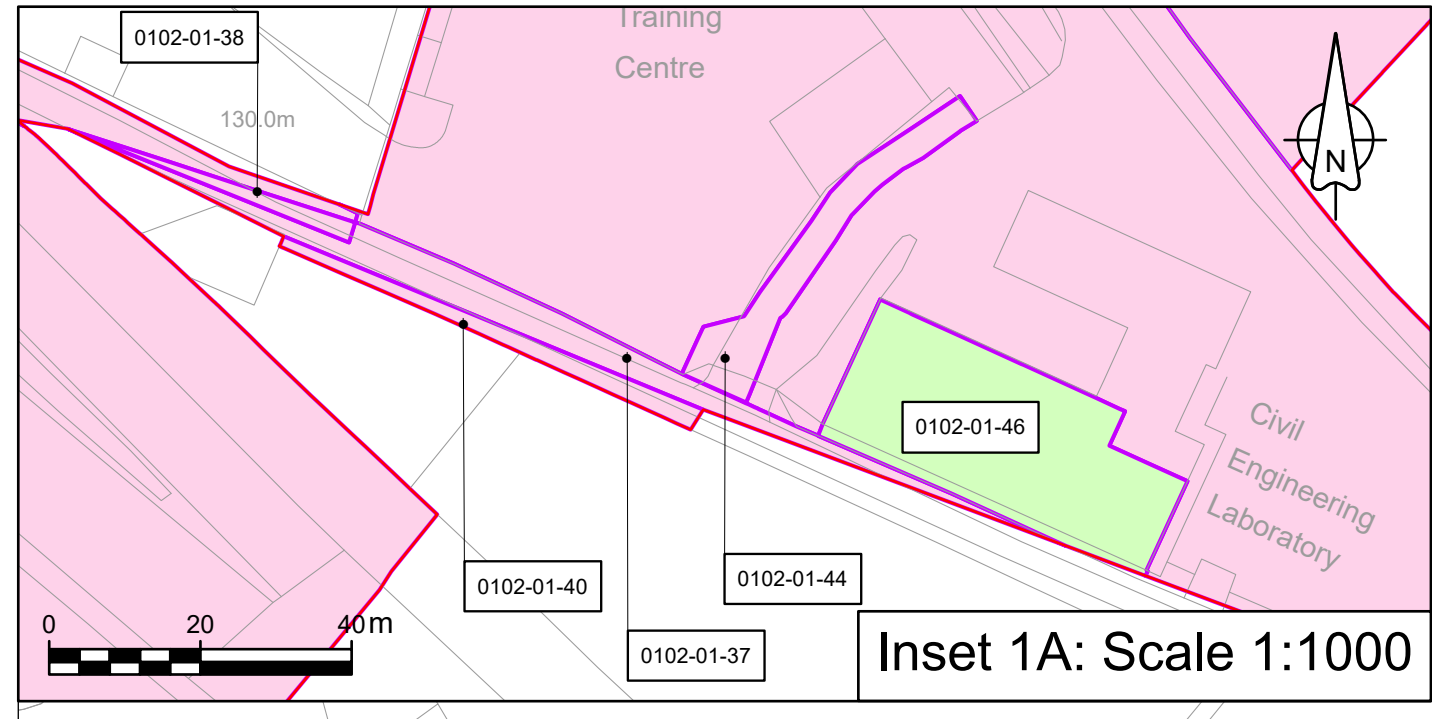

NOTES

1. ALL DIMENSIONS ARE IN METRES UNLESS STATED OTHERWISE.
2. THESE LAND PLANS SHOULD BE READ IN CONJUNCTION WITH OTHER PLANS AND DOCUMENTS IN THE DEVELOPMENT CONSENT ORDER APPLICATION IN PARTICULAR THE BOOK OF REFERENCE.
3. ALL EASEMENTS, SERVITUDES AND PRIVATE RIGHTS IN LAND ARE PROPOSED TO BE EXTINGUISHED ON LAND SHOWN COLOURED PINK ON THESE LAND PLANS. ALL EASEMENTS, SERVITUDES AND PRIVATE RIGHTS IN LAND ARE PROPOSED TO BE EXTINGUISHED SO FAR AS THEIR CONTINUED EXERCISE WOULD BE INCONSISTENT WITH THE EXERCISE OF THE RIGHTS OR RESTRICTIONS PROPOSED TO BE ACQUIRED BY THE UNDERTAKER ON LAND SHOWN COLOURED BLUE ON THESE LAND PLANS. ALL EASEMENTS, SERVITUDES AND PRIVATE RIGHTS ARE PROPOSED TO BE SUSPENDED WHILE THE UNDERTAKER IS IN TEMPORARY POSSESSION OF THE LAND SHOWN COLOURED GREEN ON THESE LAND PLANS.
4. THE NUMBER LABELS RELATE TO PLOT NUMBERS. PLEASE REFER TO THE BOOK OF REFERENCE FOR MORE INFORMATION ABOUT THESE PLOTS, INCLUDING THE APPROXIMATE AREA OF EACH PLOT (IN SQUARE METRES). PLOT NUMBERS INCLUDE A REFERENCE TO THE RELEVANT SHEET OF THE LAND PLANS. IN THIS NUMBERING CONVENTION, A PLOT NUMBER COMPRISES THE SCHEME NUMBER, FOLLOWED BY THE SHEET NUMBER (OF THE SET OF LAND PLANS RELATING TO THAT NUMBERED SCHEME), FOLLOWED BY THE ACTUAL PLOT NUMBER ON THAT SHEET, E.G. PLOT 03-01-24, WHERE 03 IS THE SCHEME NUMBER (SCHEME 03), 01 IS THE SHEET NUMBER (SHEET 01 OF THE LAND PLANS FOR SCHEME 03) AND 24 IS THE PLOT NUMBER (PLOT 24 ON SHEET 01).

KEY

- ORDER LIMITS
- PERMANENT ACQUISITION OF LAND
- TEMPORARY POSSESSION OF LAND

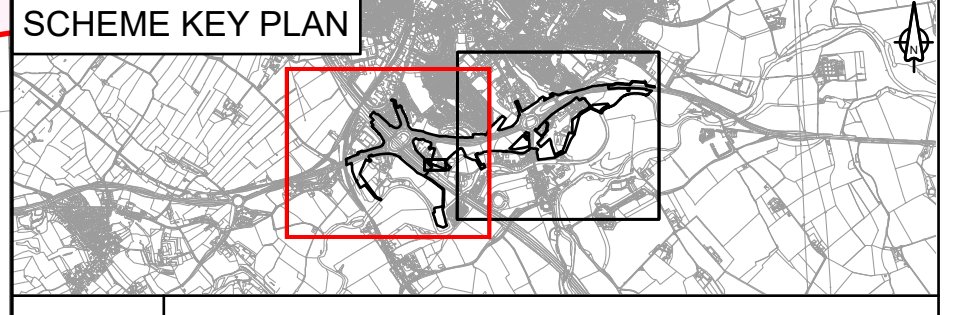
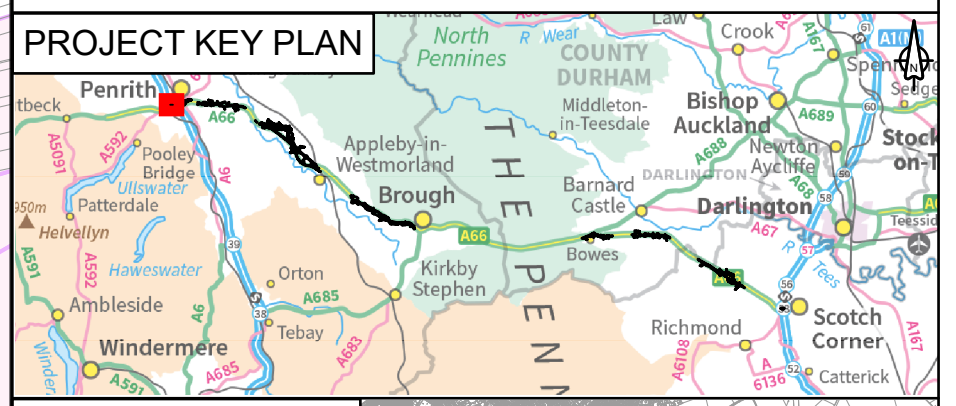

C01	JHILL	JHILL	NWHIT	GEAC	PCAR
	06/06/22	06/06/22	07/06/22	07/06/22	08/06/22
Revision details					
Revision	JHILL	JHILL	NWHIT	GEAC	PCAR
	05/05/2023	05/05/2023	05/05/2023	05/05/2023	05/05/2023

Purpose
DCO APPLICATION

PINS Reference Number
TR010062/APP/5.13

Client
3 Piccadilly Place
Manchester
M1 3BN



Project Name / Scheme Name
A66 Northern Trans-Pennine Project
Scheme 0102
M6 Junction 40 to Kemplay Bank

Drawing Title
Land Plans
Regulation 5(2)(i)
Sheet 1 of 2

Project Ref. No.	Stage	Scale	@ A1
---	PCF3	1:2500	
		Dimension	M

Drawing Number	Project	Originator	Volume
HE565627	- AMY	- HAC	-
S0102	-DR	-CH	-000002
Location		Type	Role Number

Suitability	Suitability Description	Revision
A	Approved for Stage Complete	C02

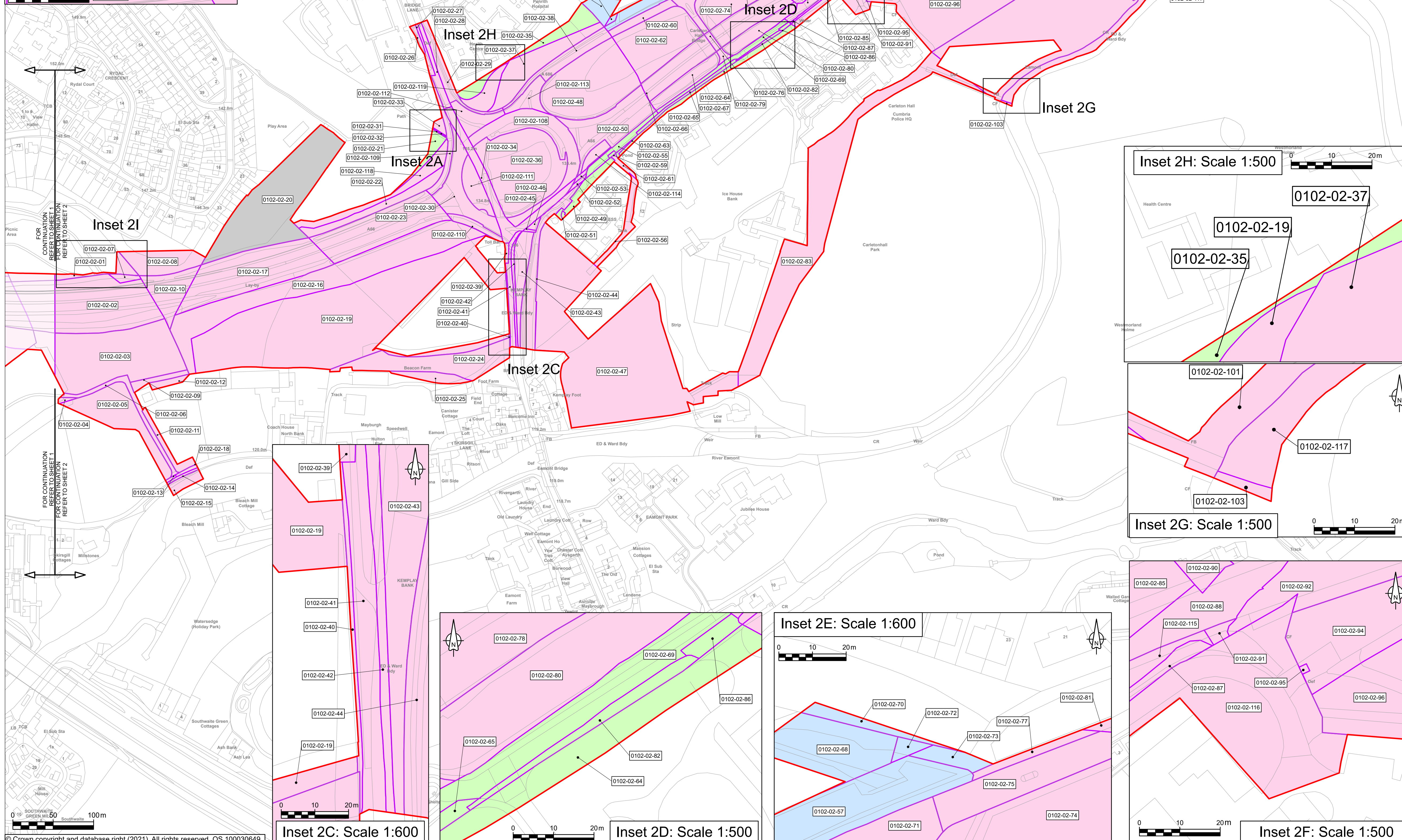
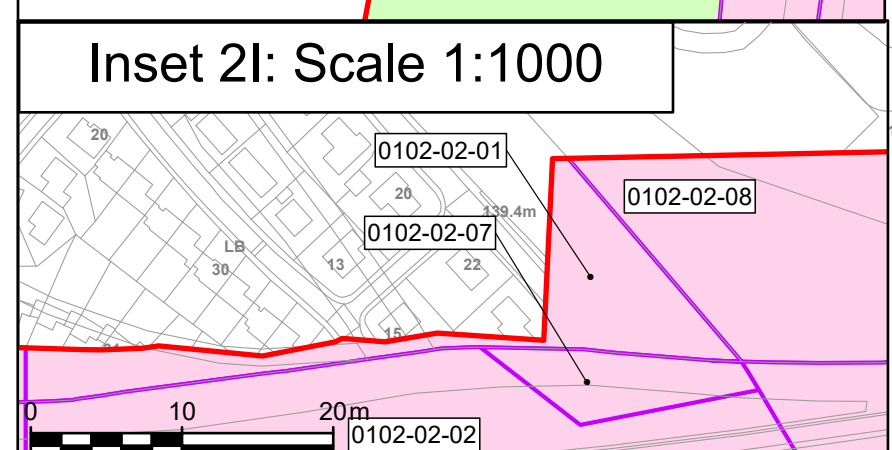
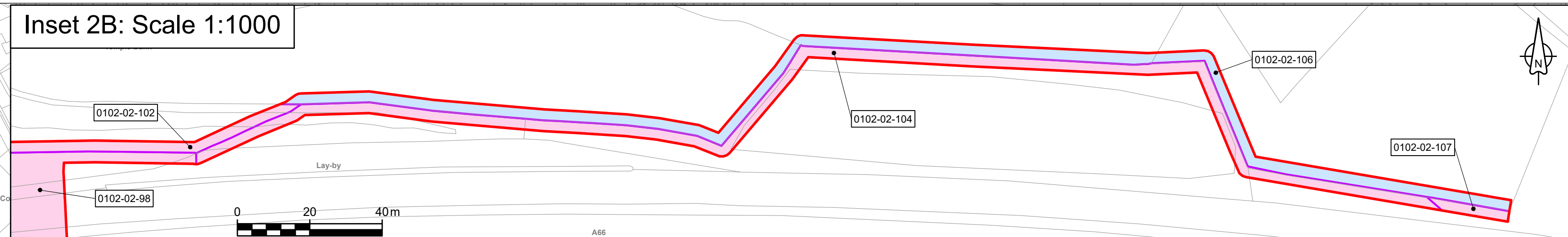
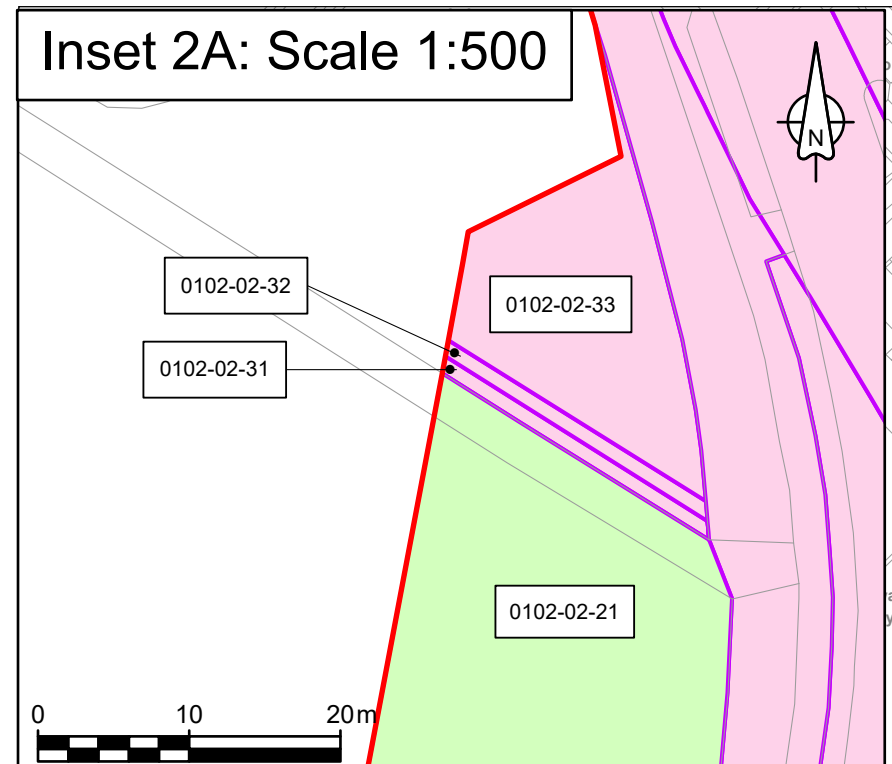

NOTES

1. ALL DIMENSIONS ARE IN METRES UNLESS STATED OTHERWISE.
2. THESE LAND PLANS SHOULD BE READ IN CONJUNCTION WITH OTHER PLANS AND DOCUMENTS IN THE DEVELOPMENT CONSENT ORDER APPLICATION IN PARTICULAR THE BOOK OF REFERENCE.
3. ALL EASEMENTS, SERVITUDES AND PRIVATE RIGHTS IN LAND ARE PROPOSED TO BE EXTINGUISHED ON LAND SHOWN COLOURED PINK ON THESE LAND PLANS. ALL EASEMENTS, SERVITUDES AND PRIVATE RIGHTS IN LAND ARE PROPOSED TO BE EXTINGUISHED, SO FAR AS THEIR CONTINUED EXERCISE WOULD BE INCONSISTENT WITH THE EXERCISE OF THE RIGHTS OR RESTRICTIONS PROPOSED TO BE ACQUIRED BY THE UNDERTAKER ON LAND SHOWN COLOURED BLUE ON THESE LAND PLANS. ALL EASEMENTS, SERVITUDES AND PRIVATE RIGHTS ARE PROPOSED TO BE SUSPENDED WHILE THE UNDERTAKER IS IN TEMPORARY POSSESSION OF THE LAND SHOWN COLOURED GREEN ON THESE LAND PLANS.
4. THE NUMBER LABELS RELATE TO PLOT NUMBERS. PLEASE REFER TO THE BOOK OF REFERENCE FOR MORE INFORMATION ABOUT THESE PLOTS, INCLUDING THE APPROXIMATE AREA OF EACH PLOT (IN SQUARE METRES). PLOT NUMBERS INCLUDE A REFERENCE TO THE RELEVANT SHEET OF THE LAND PLANS. IN THIS NUMBERING CONVENTION, A PLOT NUMBER COMPRISES THE SCHEME NUMBER, FOLLOWED BY THE SHEET NUMBER (OF THE SET OF LAND PLANS RELATING TO THAT NUMBERED SCHEME), FOLLOWED BY THE ACTUAL PLOT NUMBER ON THAT SHEET, E.G. PLOT 03-01-24, WHERE 03 IS THE SCHEME NUMBER (SCHEME 03), 01 IS THE SHEET NUMBER (SHEET 01 OF THE LAND PLANS FOR SCHEME 03) AND 24 IS THE PLOT NUMBER (PLOT 24 ON SHEET 01).

KEY

- Order Limits
- PERMANENT ACQUISITION OF LAND
- PERMANENT ACQUISITION OF LAND - REPLACEMENT LAND
- PERMANENT ACQUISITION OF RIGHTS
- TEMPORARY POSSESSION OF LAND

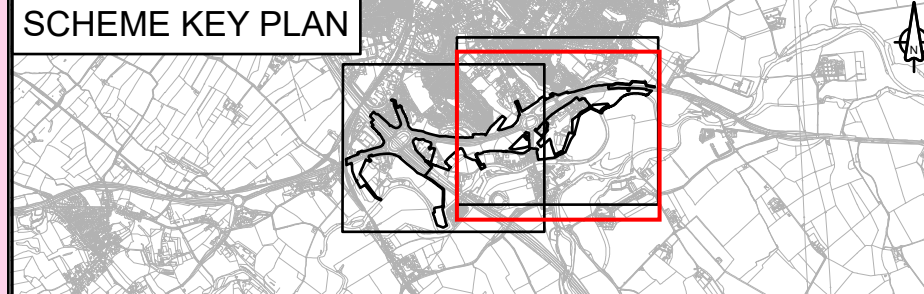
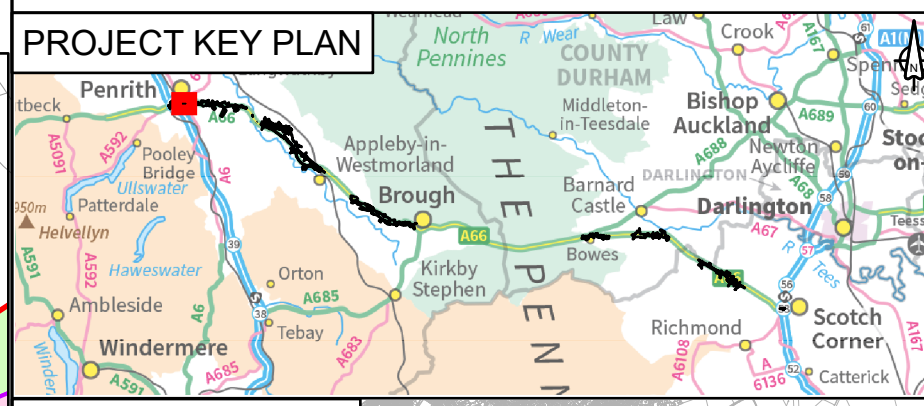

Revision	JHILL	JHILL	NWHIT	GEAC	PCAR
	06/06/22	06/06/22	07/06/22	07/06/22	08/06/22
Revision details					
	26/04/23	26/04/23	26/04/23	26/04/23	26/04/23

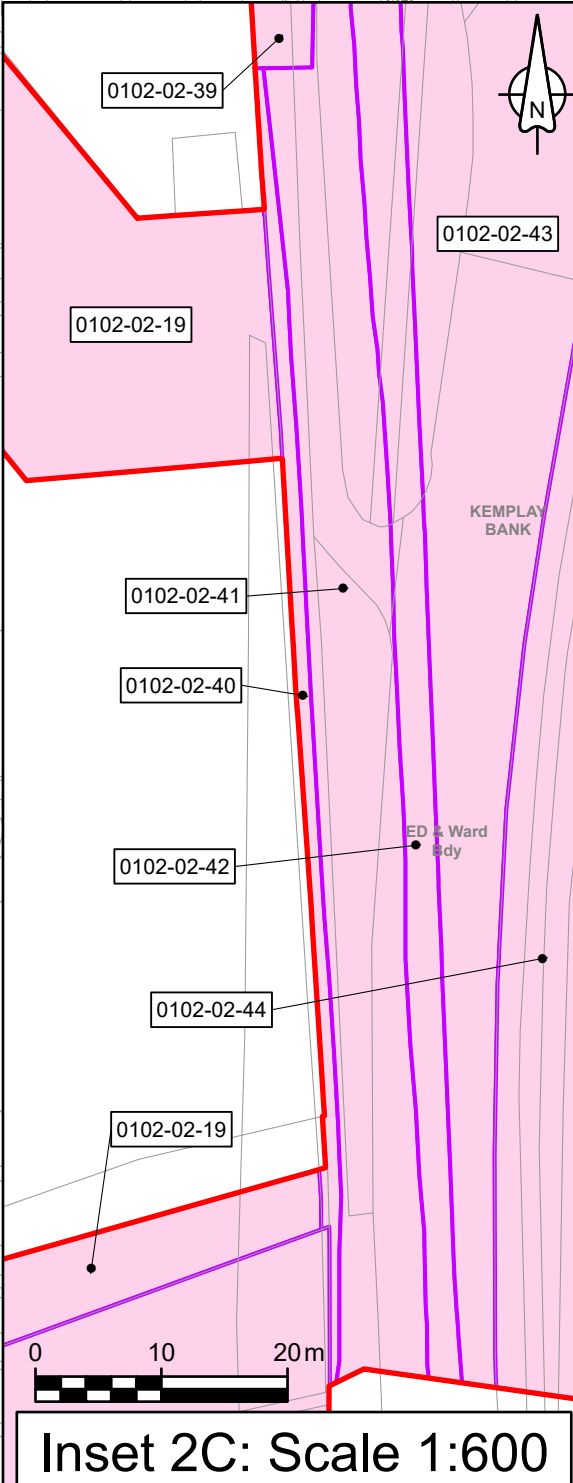
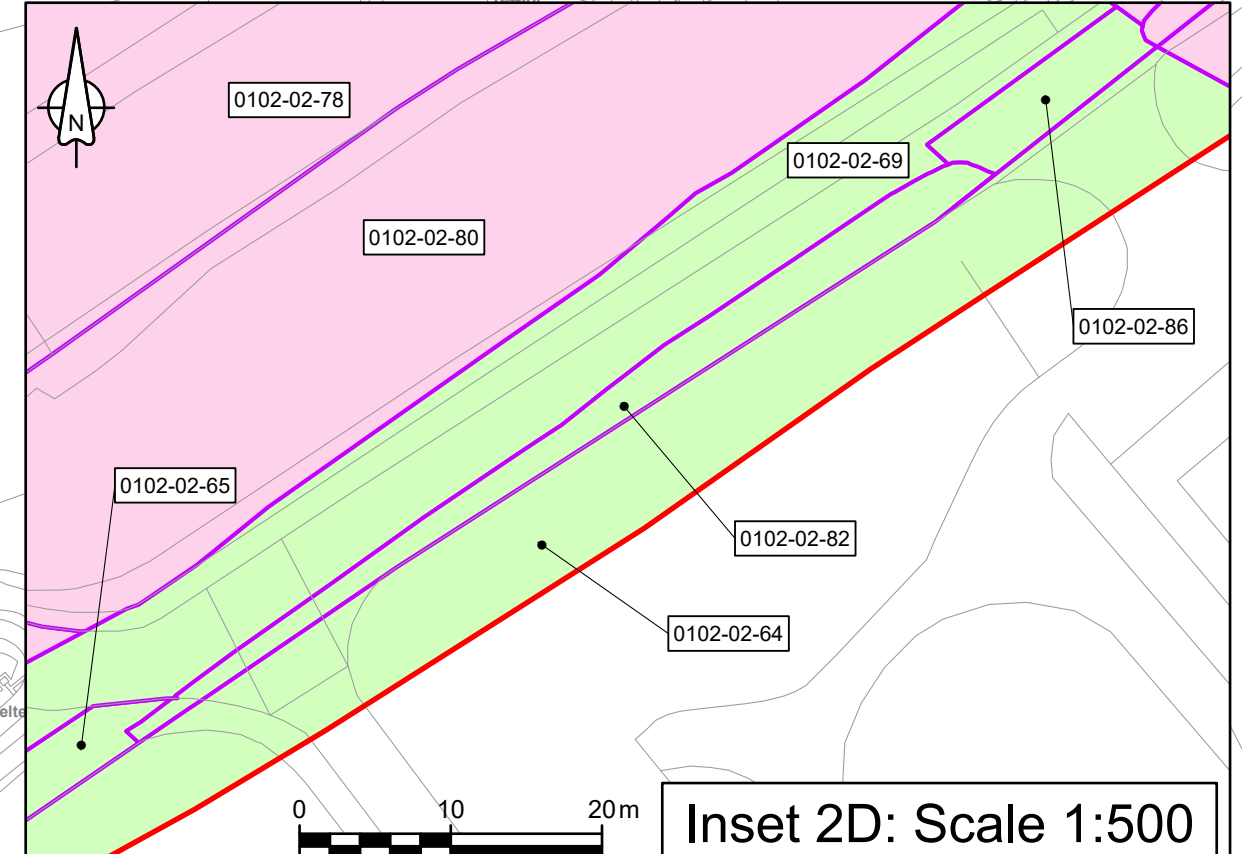
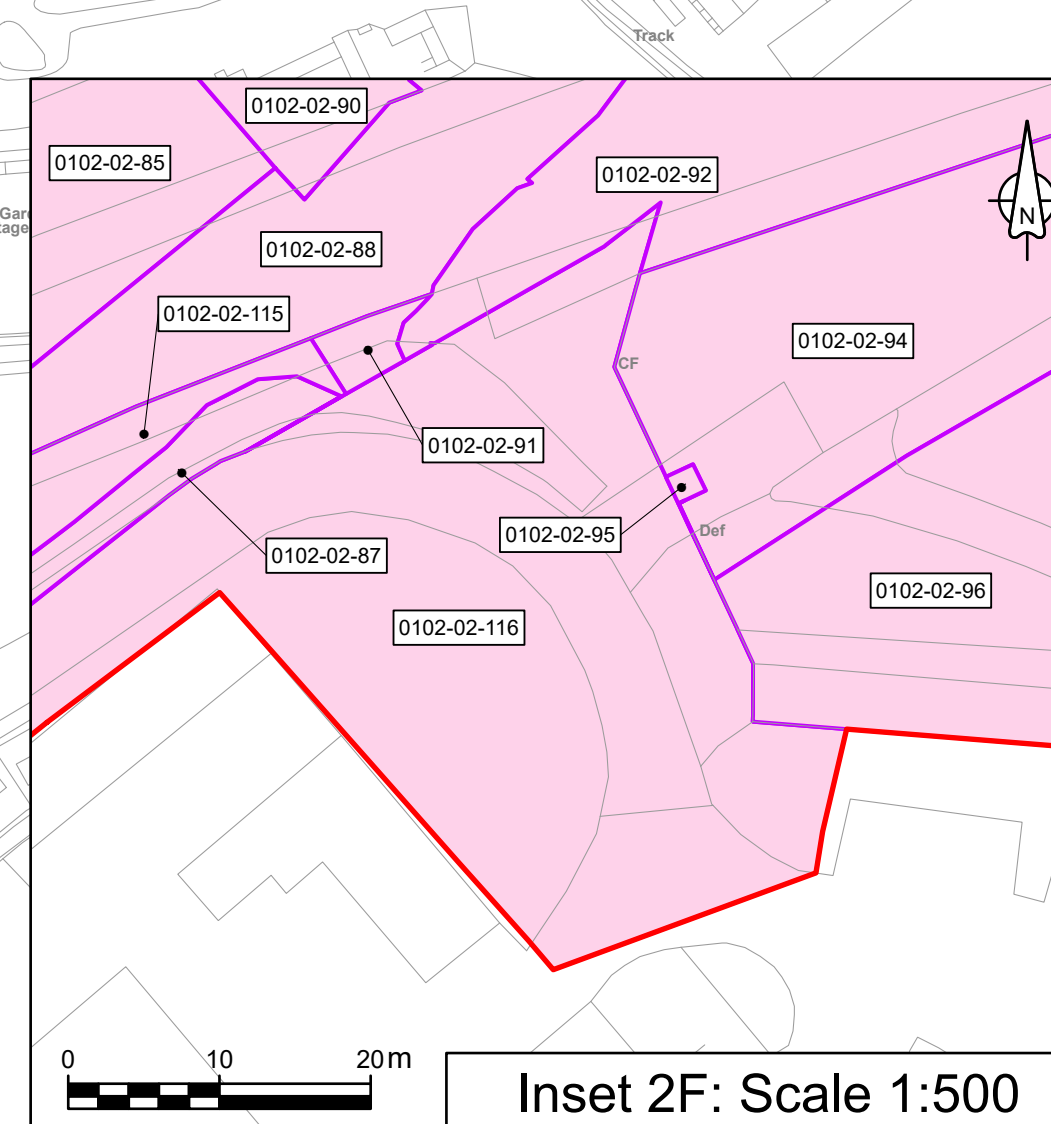
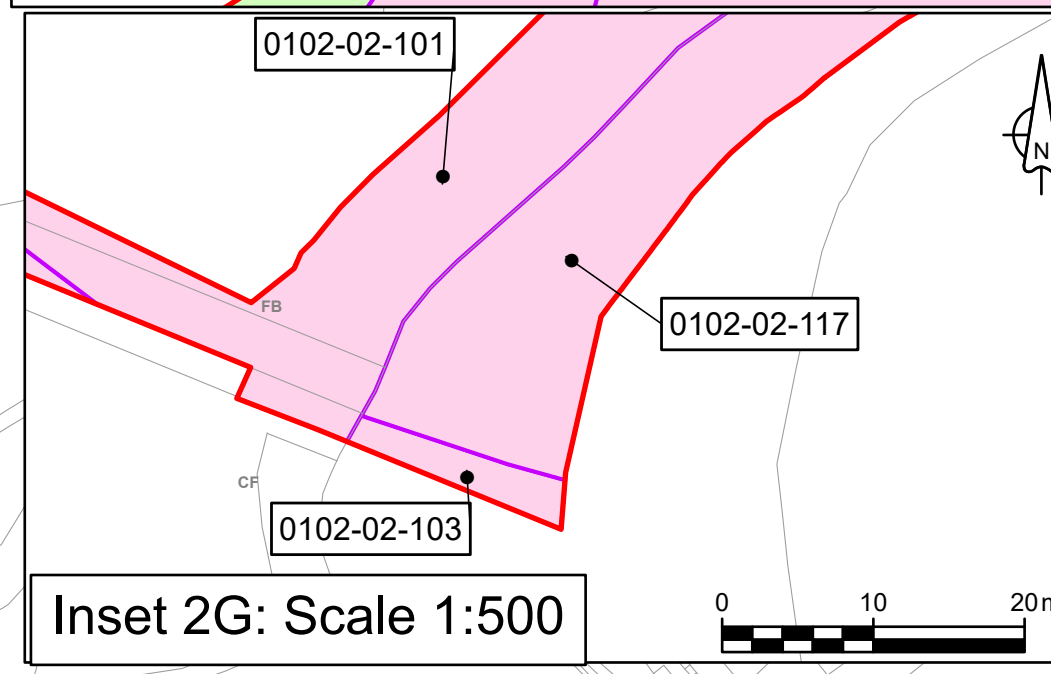
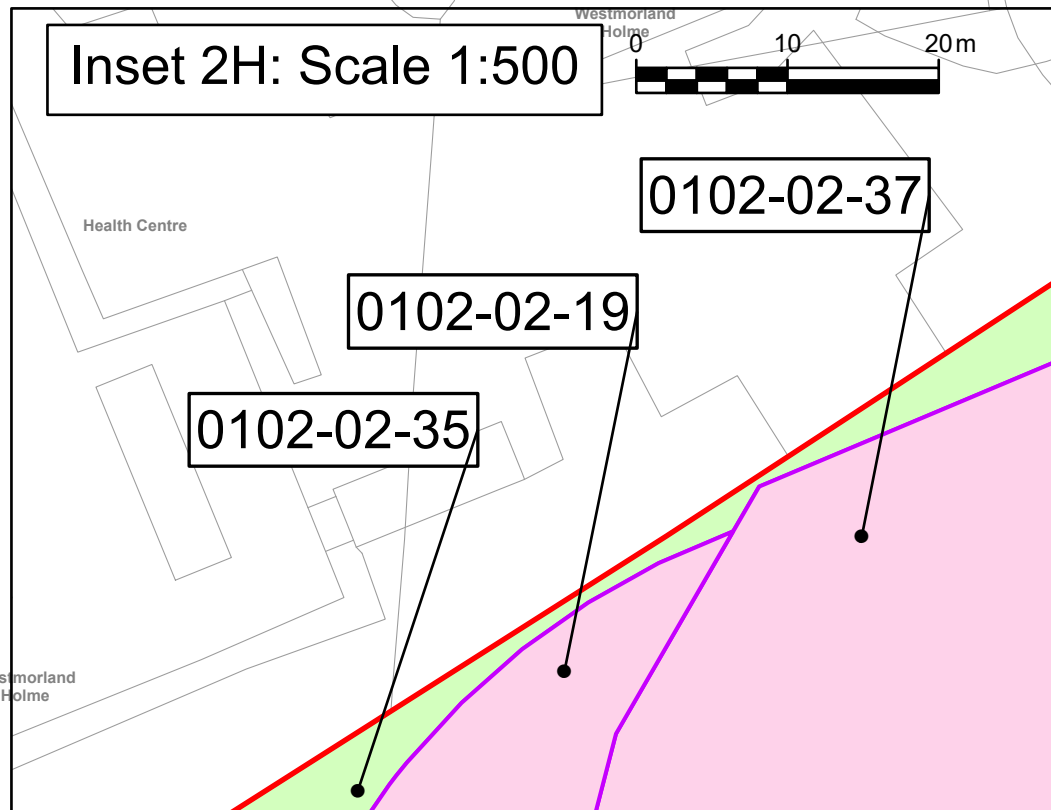

Purpose
DCO APPLICATION

PINS Reference Number
TR010062/APP/5.13

Client
3 Piccadilly Place
Manchester
M1 3BN

Project Name / Scheme Name
A66 Northern Trans-Pennine Project
Scheme 0102
M6 Junction 40 to Kemplay Bank

Drawing Title
Land Plans
Regulation 5(2)(i)
Sheet 2 of 2

Project Ref. No.	Stage	Scale	Dimension
---	PCF3	1:2500 @ A1	M

Drawing Number	Project	Originator	Volume
HE565627 - AMY - HAC -	S0102	-DR-CH-000003	
	Location	Type	Role

Suitability	Suitability Description	Revision
A	Initial non-contractual code	CO2